

IRRIGATION SYSTEM TO PROVIDE 100% COVERAGE WITH 50% OVERLAP.

ALL ON-SITE PERVIOUS AREAS NOT NOTED ON LANDSCAPE PLAN TO HAVE SHRUBS OR GROUND COVER SHALL BE SODDED BY THE CONTRACTOR; SEE SHEET L-2.4 GENERAL NOTES FOR ADDITIONAL SOD & MULCH SPECIFICATIONS

ALL LANDSCAPED AREAS TO BE FULLY COVERED BY AUTOMATIC IRRIGATION SYSTEM AS PER CITY CODES AND REQUIREMENTS. SEE IRRIGATION PLANS.

PLEASE REFER TO SHEET LA.02 FOR LANDSCAPE DETAILS, AND SHEET LA.03 FOR GENERAL NOTES.

PER CITY ORDINANCE (S) 50.02(A)(4) AND 100.35(E), LANDSCAPING MATERIALS OTHER THAN SOD ARE NOT ALLOWED WITHIN (5) FEET OF ANY PORTION OF CITY OWNED UTILITIES WITHIN THE PUBLIC STREET RIGHT-OF-WAY INCLUDING METERS, HYDRANTS, SERVICE LINES, ETC. ADDITIONALLY, NO TREES, SHRUBBERY OR OBSTRUCTION SHALL BE PLACED WITHIN 3' RADIUS OF CITY-OWNED SEWER LATERAL CLEANOUT OR WATER &/OR REUSE METER. CONTACT TRACY WYNN GIS COORDINATOR ENGINEERING DIV. FOR UTILITY INFORMATION - 954-545-7007 OR AT TRACY.WYNN@COPBFL.COM



CITY OF POMPANO BEACH - LANDSCAPE CODE COMPLIANCE CHART

POMPANO BEACH CODE OR ORDINANCES
I-1 ZONING: LANDSCAPING AND BUFFERING REQUIREMENTS

SEC. 155.5203. GENERAL REQUIREMENTS		TOTAL SITE AREA: 0.56 AC	
Tree: 12" minimum height, 2" minimum caliper Palms: 14" oa min. Shrubs: 24" hts., x 24" spr., minimum (unless otherwise required by buffer type) 50% of Required Canopy Trees Shall be Relative in Height (18') to the Structure 25% Max of Required Trees May be Palms			
SEC. 155.5203.F: REQUIRED PERIMETER LANDSCAPING ADJACENT TO R-O-W		REQUIRED	PROVIDED
a. 10' wide landscaped with grass or groundcovers	345.04' South and East Perimeter	13 TREES	12 TREES**
b. 1 Canopy tree/30 linear feet		48" HEDGE	12 PALMS**
c. 48" hedge		5 TREES	PROVIDED
d. (OH lines) 1 Understory Trees/20 lf	100.01' West Perimeter		5 TREES
SEC. 155.5203.C: MINIMUM DEVELOPMENT SITE LANDSCAPING			
a. 1 Tree/5 Shrubs per 3000 sq.ft.	(24,400 sq.ft. +/-) 0.56 Acres	9 TREES	9 TREES
b. 1 Tree/Parking Island	2 Islands	45 SHRUBS	54 SHRUBS
		2 TREES	2 TREES
SEC. 155.5203.G STREET TREES			
1 Tree/40 linear feet of street frontage Required Trees shall be Understory Trees to accommodate overhead utility lines	101.01' sw 12th Ave	3 TREES	3 TREES
			218 SHRUBS*
TOTALS		32 TREES, 45 SHRUBS	31 TREES/12 PALMS 54 SHRUBS
** Superior Landscape: Development Services Director may grant modifications if required landscaping between VUA and building provides at least 50% of required width and must include one or more of the following i. Palms must be provided in multiples (doubles or triples) ii. If palms and trees are combined, one row of shrubs can be provided iii. If palms or trees are provided, must be included in layering or height tiering with a minimum of 2 wiers iv. If trees are provided, design must include 2 species v. Trees or palms must be a minimum of 14' hts vi. Layered or height tiered shrubs are provided in variety with a minimum of two species vii. Suspended pavement systems are provided adjacent to the VUA Given the existing parameters of the adjacent building abutting the property line, the required retention, and the nature of the site (semi-trunk parking), we are proposing an alternate Superior Landscape for the south perimeter buffer planting that meets at least one of the above conditions.		*INCL PERIMETER HEDGE & "SUPERIOR" LANDSCAPE	

NOTE! THIS SITE DOES NOT CONTAIN ANY EXISTING TREES, PALMS OR HEDGES,SHRUBS OR GROUND COVERS.

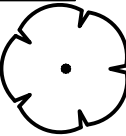
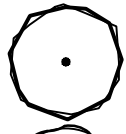
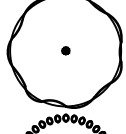
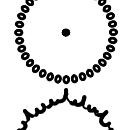
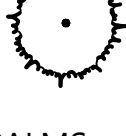
PLANT SCHEDULE

<u>SYMBOL</u>	<u>CODE</u>	<u>QTY</u>	<u>BOTANICAL / COMMON NAME</u>	<u>CONT/ROOT BALL SIZE</u>	<u>CAL/DBH</u>	<u>HEIGHT</u>	<u>SPREAD</u>	<u>NATIVE</u>	<u>XERIC</u>	<u>REMARKS</u>
TREES										
	BS	4	Bursera simaruba / Gumbo Limbo	B & B	3" cal.	14' Ht	5-6'	Yes	High	4' CT
	CE-S	3	Conocarpus erectus 'sericeus' / Silver Buttonwood	B & B	2.5"Cal	12'	4-5'	Yes	High	4' CT
	CS	6	Cordia sebestena / Orange Geiger Tree	B & B	2"Cal	14' Ht	4-5'	Yes	High	4' CT
	LI	9	Lagerstroemia indica `Tuskegee` / Crape Myrtle	B & B	2.5"Cal	12'	6-7'	No	High	4' CT
	TD	9	Taxodium distichum / Bald Cypress	B&B	2.5"Cal	12'	4'-5'	Yes	High	
PALMS										
	SP	12	Sabal palmetto / Cabbage Palmetto	B & B		18-22` ct	10`	Yes	High	stagger hts.
<u>SYMBOL</u>	<u>CODE</u>	<u>QTY</u>	<u>BOTANICAL / COMMON NAME</u>	<u>CONTAINER</u>	<u>SPACING</u>	<u>HEIGHT</u>	<u>SPREAD</u>	<u>NATIVE</u>	<u>REMARKS</u>	
SHRUBS										
	CHH	36	Chrysobalanus icaco `Red Tip` / Red Tip Cocoplum	NA	24"	24"	24"	Yes	Full to base	
	CLG	80	Clusia guttifera / Small Leaf Clusia	-	42"	48"	42"	No	Full to base	
	TRD	48	Tripsacum dactyloides / Fakahatchee Grass	n/a @	30"	30"	24"	Yes	Full to base	
<u>SYMBOL</u>	<u>CODE</u>	<u>QTY</u>	<u>BOTANICAL / COMMON NAME</u>	<u>CONTAINER</u>	<u>SPACING</u>	<u>HEIGHT</u>	<u>SPREAD</u>	<u>NATIVE</u>	<u>SPACING</u>	<u>REMARKS</u>
SHRUB AREAS										
	JAS	54	Jasminum simplicifolium / Southern Wax Jasmine	n/a @	24"	16"	18"	No	24" o.c.	Full to base

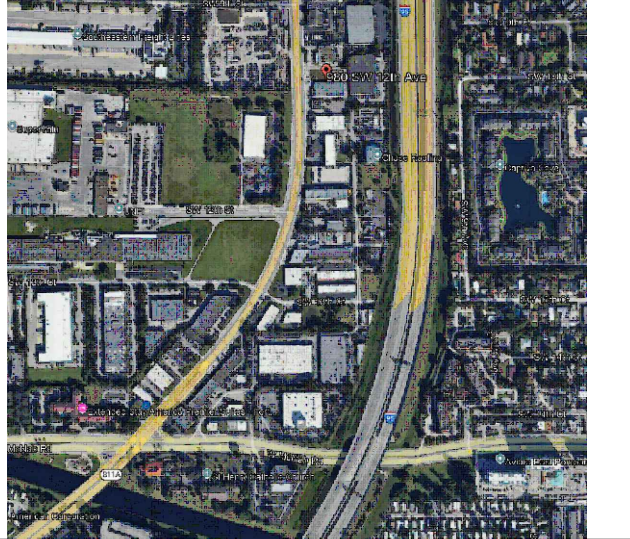

LOCUS MAP
N.T.S.

THIS DOCUMENT, AS AN INSTRUMENT OF SERVICE, IS THE SOLE PROPERTY OF WDA DESIGN GROUP, INC. ITS USE BY THE OWNER FOR OTHER PROJECTS OR FOR COMPLETION OF THIS PROJECT BY OTHERS IS STRICTLY FORBIDDEN. DISTRIBUTION IN CONNECTION WITH THIS PROJECT SHALL NOT BE CONSTRUED AS PUBLICATION IN DEROGATION OF WDA DESIGN GROUP'S RIGHTS. 6/2024, WDA DESIGN GROUP, INC.

REV.	DATE	INITIAL ISSUE	DESCRIPTION	INIT.
A				

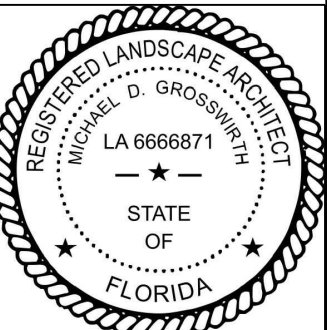

PREPARED BY:

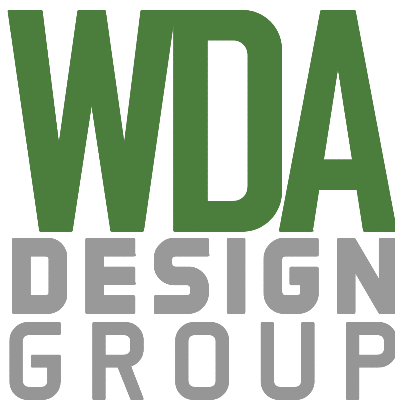

OWNER:

JOEFFRAN INVESTMENTS

PREPARED FOR:

THOMAS ENGINEERING GROUP
6300 NW 31ST AVE
FORT LAUDERDALE, FL 33309
BROWARD COUTY, FL

TITLE:

LANDSCAPE PLAN

980 SW 12TH AVE
POMPANO BEACH, FL

DRC

DRC

JOB NO.: 1632 DATE: 04/02/25
DWN. BY: MDG SHEET: LA.01
PZ25-1200010